

Specifications:

Catalogue Number	Network Type	Mounting	Colour	Decal	Supply Voltage	Input Power
684730	None (SPU)	Recessed mounted	White	Running man*	230-240V a.c. 50Hz	2.7W (high rate charge) 2.3W (low rate charge)
684730/D	DALI					
684740	Axiom					
684731	None (SPU)	Surface mounted	White	Running man*		
684731/D	DALI					
684741	Axiom					
684732	None (SPU)	Surface mounted	White	None (ordered seperately)		
684742	Axiom					
684733	None (SPU)	Surface mounted	Black	Running man theatre (green on black)		
684733/D	DALI					
684743	Axiom					

*4 decals are provided - Running Man, Running Man Left, Running Man Right, Opaque white

Note:

This sign is configured for maintained operation only.
Non-Maintained (switched active) operation is available by special order.

Surface- and Recessed Mounted

NOTE: To make decal replacement easier, remove body from mounting plate.

Lift tab to release then slide plate from body.

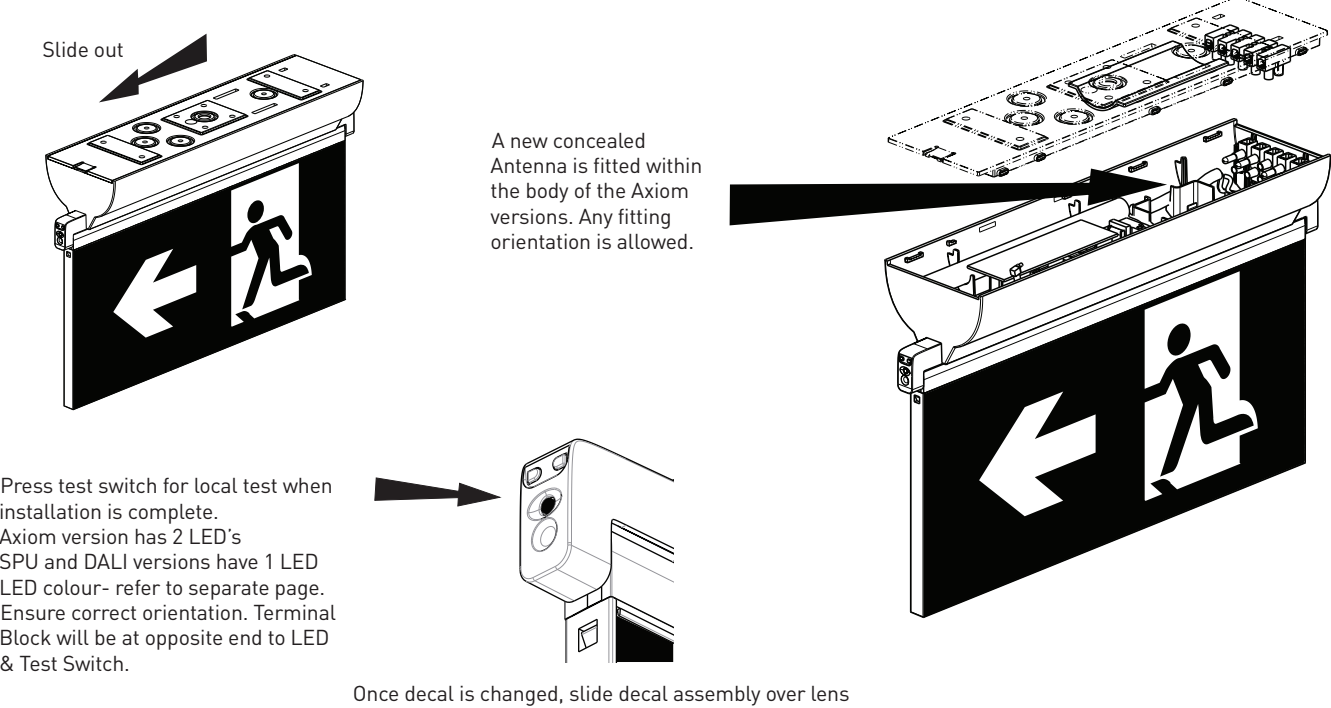

How to replace decal/s before installing body to bracket

Step 1: Use 3mm slot screwdriver to detach original decal. Depress metal clips at each end to release the decal cover assembly.

Step 2: Clean the lens before inserting decal.

Step 3: Once decal is changed, slide decal assembly over lens to click into position.

Step 4: Decal assembly will lock into place.

Surface Mounted

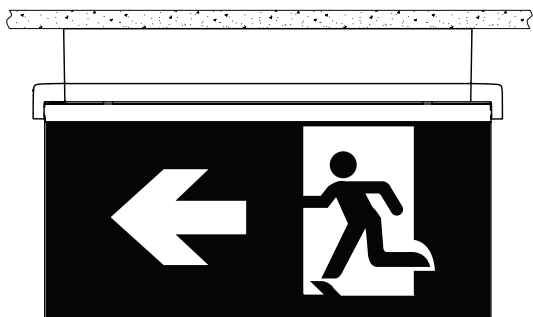

Ceiling mounted

Step 1: Fit the required decal/s as described on page 2.
Step 2: Secure the mounting plate to the wall or ceiling.

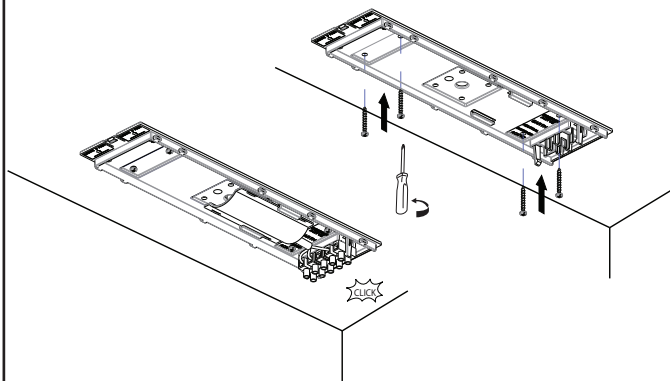

Step 3a: Terminate Unswitched Active, Neutral and Earth supply cables to terminal block.

Step 3b: Terminate DALI cables to terminal block (DALI models only)

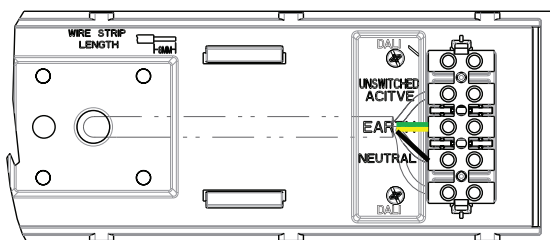

Step 3c: Fit the protective cover to the cableway.

Step 4a: Fit the body to the mounting plate by raising it to ceiling level.

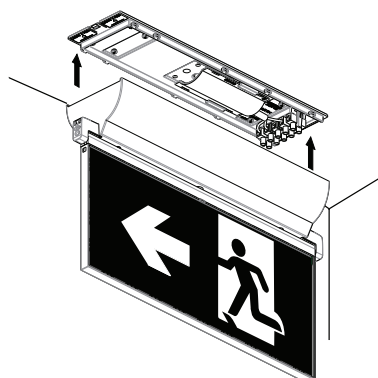

Step 4b: Locate and slide cover horizontally towards the terminal block until it connects securely.

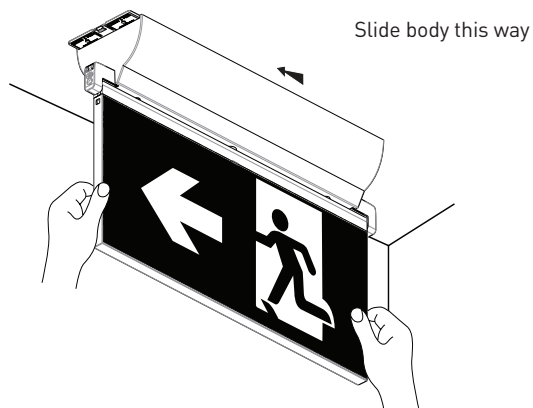

Step 5: Apply power to the sign and confirm that:

- Indicator LED is flashing.
- Running Man is illuminated.

Removal

To remove the body from mounting plate, push tab up and slide out the body as shown.

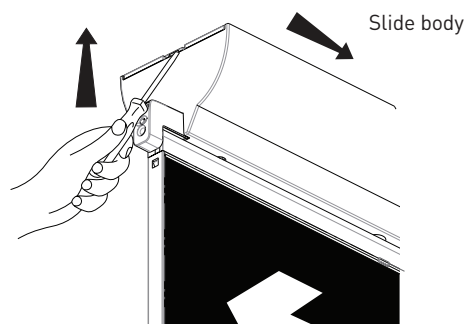

E2 EDGELIGHT LED EXIT SIGN

Recessed Edgelight

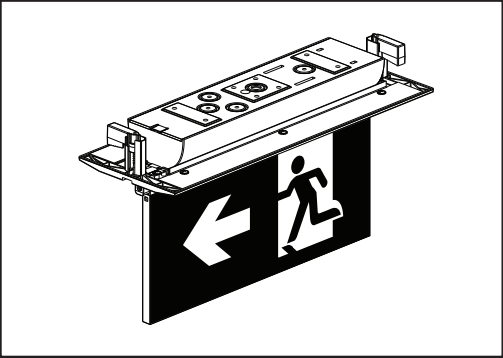

Step 1: Fit the required decal/s as described previously.

Step 2: Ensure Unswitched Active is available adjacent to where the sign will be installed.

Step 3: Determine a compliant location before cutting.

Step 4: Use the cut-out template provided to cut an exact opening.

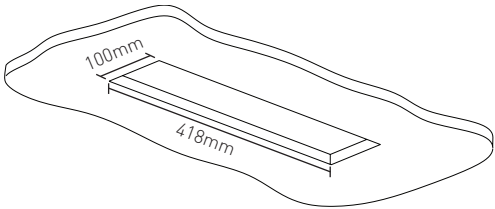

Step 5: Terminate the Unswitched Active, Neutral and Earth supply cables to the terminal block on the plate provided or fit an Australian approved flex and 3-pin plug as required, enlarging the selected entry hole to suit a cable gland. Terminate DALI cables to the terminal block (DALI models only).

Step 6: Fit the protective cover to the cableway and secure the slide-on cover to the Exit body as described previously.

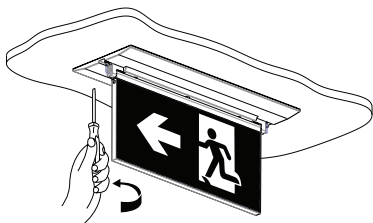
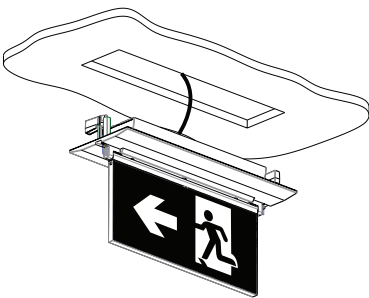
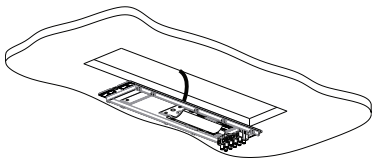

Step 7: Note the orientation of the plate so that the LED and Test Switch will be most visible and accessible. Plug in the fixture before fixing the luminaire and recessing plate securely to the ceiling using the swing clamps provided. Don't over-tighten the screws or damage to the ceiling tile may occur.

Replacement Parts:

686240	Battery Pack AA4LNICD	686218	Decal - Running Man Left
684736	E2 Recessing Plate Kit WE	686219	Decal - Running Man Right
684737	E2 Mounting Block Kit WE	686220	Decal - Running Man Theatre (Green on Black)
684738	E2 Recessing Plate Kit Black	686219	Decal - Running Man Right
684739	E2 Mounting Block Kit Black	686228	Decal - Opaque (no light transmitted)
685735	Lens Replacement Kit	686229	Decal - Black Opal (translucent)
686217	Decal - Running Man	686230	Decal - Custom Printing
682026	E2 conversion plates (2 pcs) to enable upgrade from discontinued Recessed Optica Bladelight Exit.		

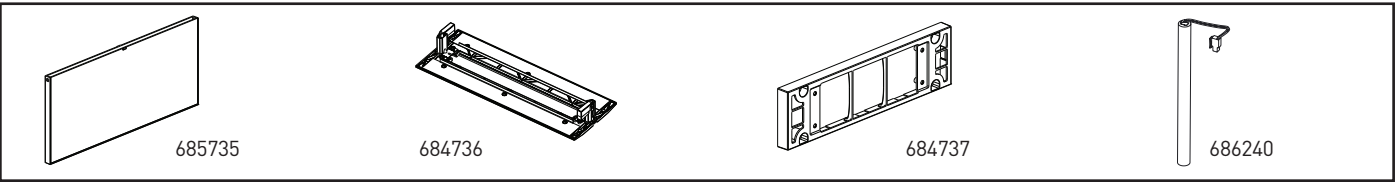

Product Legacy Upgrade Options:

Where possible, Legrand develops replacement sub-assemblies of latest generation light source and electronics for the upgrading of obsolete items from previous generations. 682026: A special adaptor plate has been designed enabling the new E2 Recessed Edgelight to be installed in place of the discontinued Optica Bladelight Recessed fluorescent exit sign.

Customer Service

For all Customer Service and Technical Support enquires please call Monday to Friday during business hours.

HPM Legrand Australia
1300 369 777
www.legrand.com.au

HPM Legrand New Zealand
0800 476 009
www.legrand.co.nz

ABN: 31 000 102 661