

ERFURT LED EXTREME m1200

4030lm, PMMA Transopal® (impact strengthened), 840/4000K, narrow beam

Article No: 433 480 24 21

LED

EL

IP 65

CE

□

▽

LUCON®

IK 04 PMMA

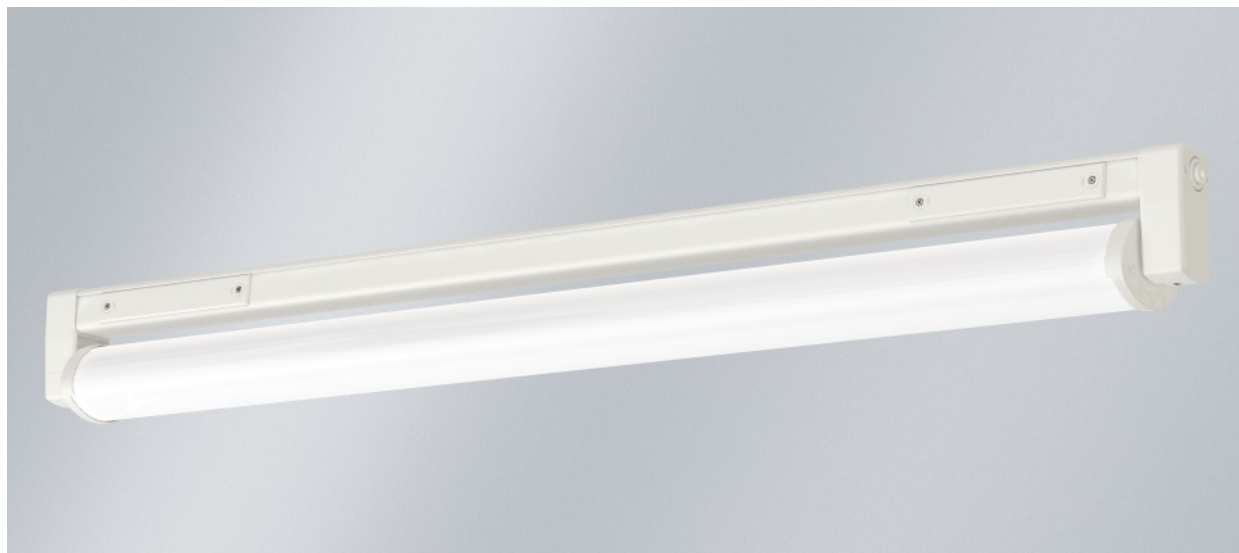
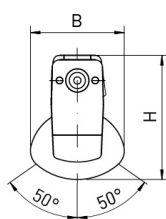
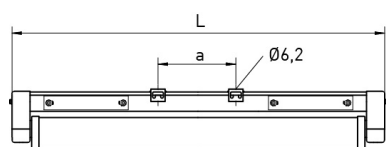



illustration may differ



 narrow beam

DIMENSIONS

L	B	H	a	b	max. weight
1251 mm	107 mm	140 mm	590 mm	-	2.8 kg

DESCRIPTION

Ceiling and wall surface-mounted polymer luminaire with LED lamps. Luminaire housing made of weatherproof, fibreglass-reinforced polymer. Thermally separated lamp chamber and transformer chamber. Short sealing system consisting of age resistant, form retaining silicone/synthetic rubber. Reflector tube that can be swivelled with internal aluminium reflector (MIRO-SILVER®). Reflector tube can be locked in steps of 10°. Built-in transformer. Ready for connection via lateral access covers, two M20 cable entries on face side and through wiring. Ceiling fixing using two stainless steel mounting clips; variable mounting distance.

created on: 2018-10-04 (ext.) Subject to technical changes without prior notice

ERFURT LED EXTREME m1200

4030lm, PMMA Transopal® (impact strengthened), 840/4000K, narrow beam

Article No: 433 480 24 21

CHARACTERISTICS

IP-rating optional	, IP67 (optional)	Lamp power	1 x 25 W
Version	m1200	System power	28 W
Lamp	LED	Colour temperature	White, 840/4000 K, Ra > 80
Lamp service life	L80 B10 > 100.000 h at +65°C	Luminous flux lamp	4030 lm
Extreme-temperature	-40°C to +65°C	Protection class	II
Number of lamps	1-lamp	IP-rating	IP65
Cover material	polymer	Type of gear	LED operating device current-controlled, Not dimmable, 220 V - 240 V AC/DC
Colour housing	White, similar to RAL 9010	Through-wiring	4 x 1,5 mm ²
Cover	reflector tube	Impact strength	IK04
Light distribution	narrow beam	Installation type	Cable suspension, Surface mounting, ceiling mounting, wall mounting, single mounting, row mounting, mounting rail, suspension system
CLO (optional)	YES	Transient protection	4 kV
Manufacturer warranty	8 years		
EL (Emergency Lighting)	optional		

DIAGRAMS

